



PART NUMBER

PFR5-5630-10

DESCRIPTION

REAR SHOCK ABSORBER TOP MOUNT BRACKET AND BUSH 10mm

INSTALLATION GUIDE

Contents (parts per pack):

- 4 x Polyurethane Bushes
- 1 x PTFE/Silicone Grease
- 2 x Stainless Steel Sleeves
- 2 x Zinc Plated Mild Steel Strengthening Plates
- 2 x Aluminium Brackets

Please read the complete fitting instructions and check package components before fitment. These fitting instructions are to be used as a guide and in conjunction with workshop manual.

It is recommended that:

- all work to be carried out by a licensed technician;
- all safety precautions adhered to;
- wheel alignment to be checked and adjusted as required after any suspension work.
- All fasteners must be tensioned to manufacturer's torque settings.



Fitting Instructions:

1. Remove the original rear shock top mount from the car and shock absorber.

Note: the original washers either side of the mount need to be kept as they are reused.

2. Reassemble the top mount, the bracket fits from the underside with the studs going up through the panel., as shown in Figure 1.

3. Apply some of the supplied grease to the bore of the polyurethane bush and insert the sleeve so that it sits flush in the bush.

4. Fit the strengthening plate from the inside of the boot.

5. Refit the mount back to the vehicle and tension all hardware to manufacturers recommended torque settings.

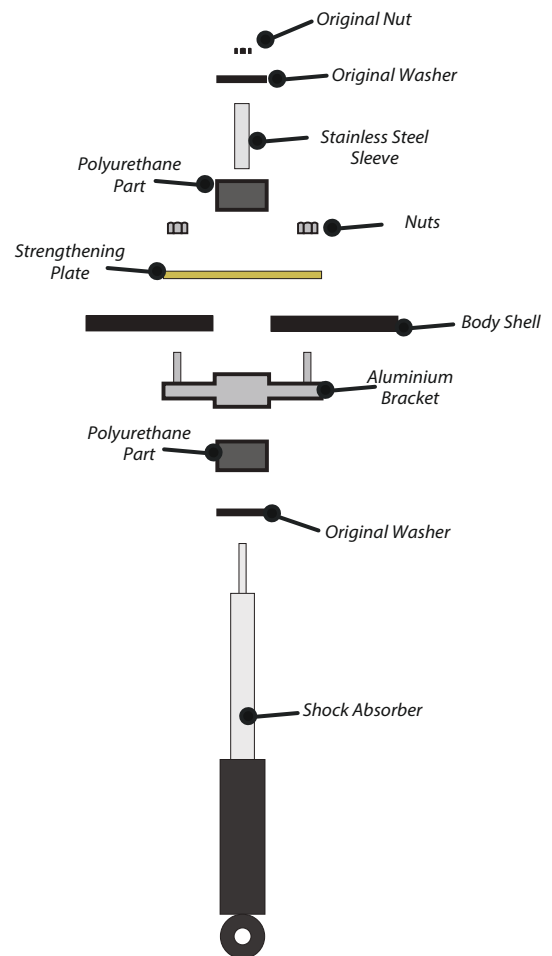

Figure 1